

LEG

LEG FOR FLEXHOOD

Leg, for floor mounting of a modular extraction hood (max. 4 legs per hood). Fixation on the floor by leg mounting plates (to be ordered separately). The leg is supplied as an option.



SPECIFICATIONS

| ■ Physical dimensions and properties | |
|--------------------------------------|--------------------|
| Length | refer to Table 1 |
| Material | aluminium |
| Colour | anodized |
| Weight (net) | refer to Table 1 |
| ■ Product combinations | |
| Floor mounting set | one set per 4 legs |
| Corner reinforcement set | one set per 2 legs |
| ■ Scope of supply | |
| Leg | |
| ■ Order information | |
| Article number | refer to Table 1 |
| Number/package | 1 |
| ■ Shipping data | |
| Gross weight | refer to Table 1 |
| Packing dimensions | refer to Table 1 |
| Harmonized Tariff Code | 8421.9900.99 |
| Country of origin | the Netherlands |

TOP VIEW



DIMENSIONS

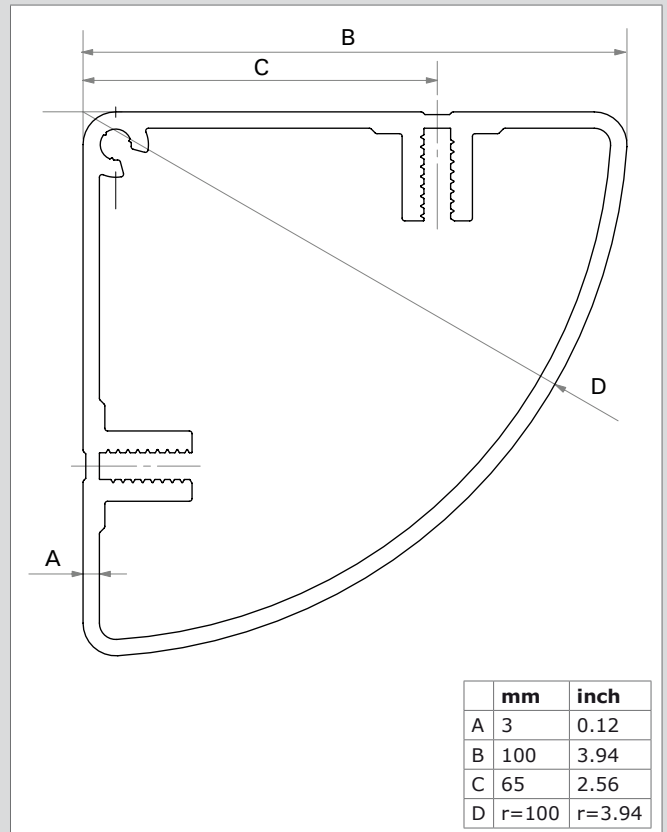
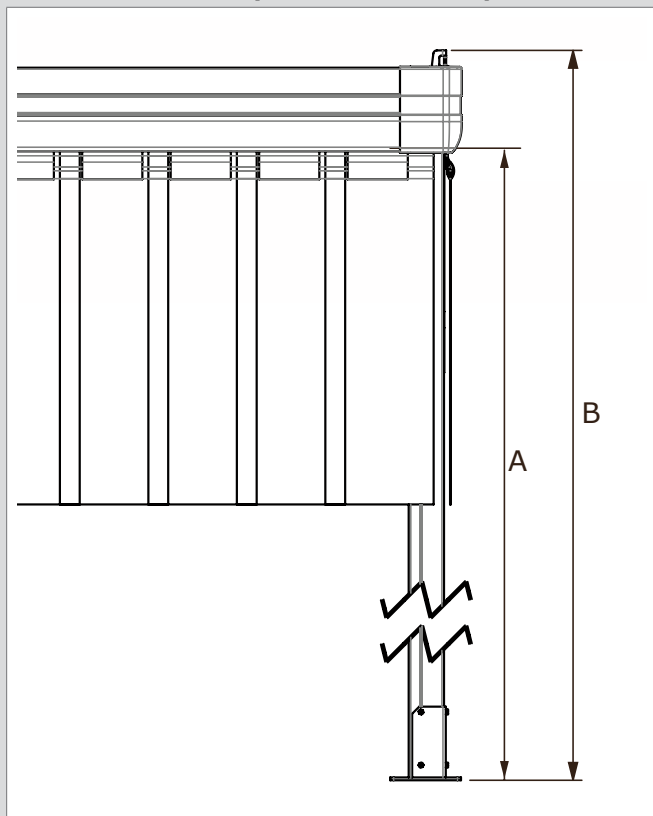

Table 1: Variables

| Type | Leg 2 m | Leg 2,5 m | Leg 3 m | Leg 3,5 m |
|--|---|--|--|--|
| Article number | 9750700010 | 9750700020 | 9750700030 | 9750700040 |
| Length | 2240 mm (88.2 in.) | 2740 mm (107.9 in.) | 3240 mm (127.6 in.) | 3740 mm (147.2 in.) |
| Height assembled hood (image below; ref. B) | 2326 mm (91.6 in.) | 2826 mm (111.3 in.) | 3326 mm (130.9 in.) | 3826 mm (150.6 in.) |
| Height underneath main frame profile (image below; ref. A) | 2000 mm (78.7 in.) | 2500 mm (98.4 in.) | 3000 mm (118.8 in.) | 3500 mm (137.8 in.) |
| Weight (net) | 8 kg (17.6 lbs) | 10 kg (22 lbs) | 12 kg (26.5) | 14 kg (30.9 lbs) |
| Weight (gross) | 9,5 kg (21 lbs) | 12 kg (26.5 lbs) | 14,5 kg (32 lbs) | 17 kg (37.5 lbs) |
| Packing dimensions | 2300 x 120 x 120 mm (91 x 4.7 x 4.7 in.) | 2800 x 120 x 120 mm (110 x 4.7 x 4.7 in.) | 3300 x 120 x 120 mm (130 x 4.7 x 4.7 in.) | 3800 x 120 x 120 mm (150 x 4.7 x 4.7 in.) |

EFFECTIVE LENGTH (REFER TO TABLE 1)



FEATURES

Combined ceiling/floor mounting



Product type

Leg

Article no.

refer to Table 1

Product category

options and accessories

Version

200411/D

Always check the latest version on www.plymovent.com.